

GRV 850S

Scambiatori Serie GRV

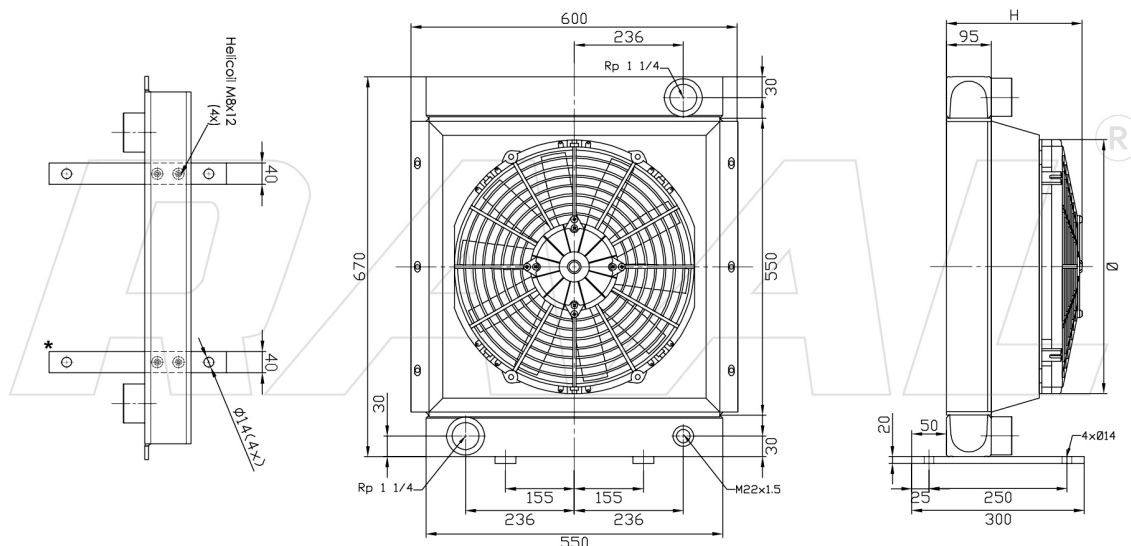

[*] Piedi rimovibili

Gamma Scambiatori

Codice Prodotto	Tipologia Allestimento	Ingombro H	Ventola diam.	Portata Ventola m3/h	M.R. dm3	Potenza Assorbita
RU0105700000	NUDO	95	-	-	28,74	-
RU0105700211	12V Asp.	290	2 x 305	3678	28,74	33,0 A
RU0105700212	12V Soff.	290	2 x 305	3472	28,74	29,8 A
RU0105700221	24V Asp.	290	2 x 305	4322	28,74	20,6 A
RU0105700222	24V Soff.	290	2 x 305	4100	28,74	18,2 A
RU0105700031/32	230V-50/60Hz Asp./Soff.	310	500	9850	28,74	3,88 A
RU0105700231/32	230V-50/60Hz Asp./Soff.	255	2 x 300	7490	28,74	3,1 A
RU0105700041/42	230/400V-50/60Hz 3FN Asp./Soff.	310	500	9195	28,74	1,41 A
RU0105700241/42	230/400V-50/60Hz 3FN Asp./Soff.	255	2 x 300	6700	28,74	0,96 A
RU0105700051	Pred. Hydraulic. Asp. (Supp. G2)	305	500	13300	28,74	4,1 kW
RU0105700052	Pred. Hydraulic. Soff. (Supp. G2)	305	500	13300	28,74	4,1 kW

Dati Tecnici

Range Minimo

Kw 26 : 40 lt

Range Massimo

Kw 44 : 200 lt

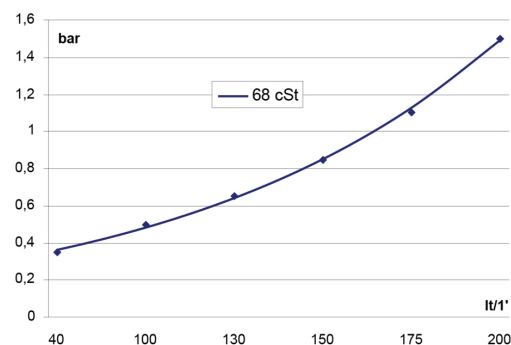
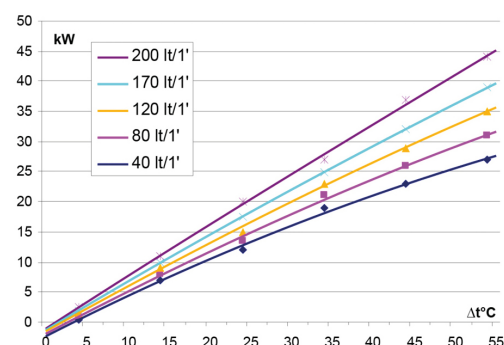

Le dimensioni di ingombro e le caratteristiche tecniche sono da considerarsi indicative, trattandosi di prodotti standard in continua evoluzione.

